

### KEY FEATURES

- Available as both internally or externally opening hinged door to suit a range of applications.
- Series 729 incorporates ThermalHEART® technology giving a true wide thermal break between the outside and inside faces. ThermalHEART® systems perform up to 32% better than traditional aluminium windows and doors.
- The doors have been tested for compliance with the relevant Australian Standards and achieved a high water resistance of 380Pa for external swing doors and 150Pa water resistance for internal opening doors, making the product suitable for most residential applications.
- Low air infiltration suitable for air-conditioned buildings.
- The extra strong door facilitates oversize door panels.
- Doors can be fitted with a variety of custom lever sets (ICON™ or MIRO™) with Lever Compression Lock (LCL) motor as standard.
- ThermalHEART® will accept insulating glass units up to 32mm thick. The typical IGU thickness is 24mm.

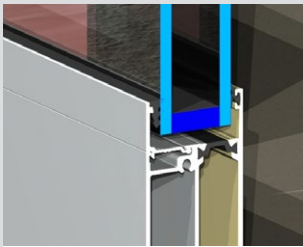

Double glazing is used as standard to obtain maximum thermal performance. Dual colour option available as illustrated above.



The hardware used on the 729 has been specifically designed for the product. Hinges nest into stile and frame – no shims required. The illustration above shows our parliament hinge that will allow panels to open against the wall.



We offer 4-point lever compression as standard. This ensures high performance seals and improves air infiltration resistance. ICON™ 316 stainless steel furniture shown above.

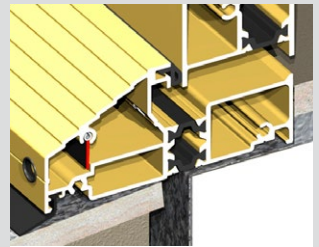

We have designed and tested hinged doors that open in and doors that open out with custom thermally broken sills that keep water out.

#### GENERAL

**Max Frame Height\***  
2600mm

**Max Panel Width\***  
900mm

**Max Glass Thickness**  
32mm

**Frame Depth**  
100mm

#### ENERGY

**UW Range**  
2.3-4.9

**SHGC Range**  
0.13-0.48

#### WEATHER

**Maximum Water**  
380 Pa. (open-out)  
150 Pa. (open-in)

#### ACOUSTICS

**19mm Insulated Glass Unit**  
Rw 33

Acoustic Numbers  
Based on Series  
548 Hinge Door



\*Dimensions subject to individual site conditions.  
BAL-40 compliance may limit glass options. Maximum glass size for BAL-40 products is 5m<sup>2</sup>.  
[vantagealuminium.com.au/729](http://vantagealuminium.com.au/729)