

### KEY FEATURES

- Versatile commercial CentreGLAZE™ framing system ideal for commercial or residential applications.
- True captive glazing wedge on one side. In elevated installations with bead on the inside at head this allows you to glaze and reglaze from inside the building, no need for scaffolding.
- External wet top Silicone glazing also available.
- Numerous custom designed extrusions to cater for specific applications. A range of sub-sills cover most installations including residential installations into cavity brick and brick veneer walls.
- Sub-head and two piece sub-jamb.
- Numerous door thresholds including weather resisting thresholds for external and internal swing doors.
- Top hung and bottom rolling sliding door track systems.
- Compatible with Series 50, 51 and 52 doors.

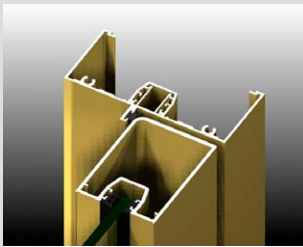

Our 50mm thick doors are about 70% stronger than industry standard 44mm thick panels. This is important if you want to make doors higher than 2100mm.

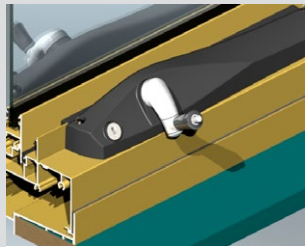

Series 400 framing is the building block of commercial applications and will accept a variety of opening sash options from sliders to double-hung to awning and casement.

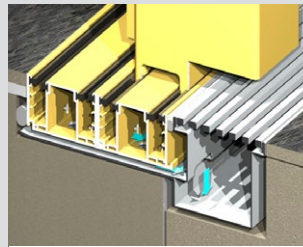

Can accept sliding door panels in a variety of commercial applications. This fully recessed sill is completely flat and still keeps water out. Complies with AS1428.

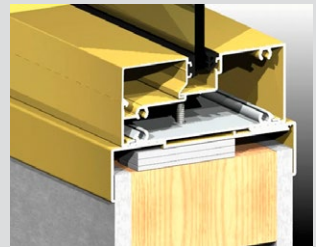

We offer a range of internal trim options to make installation into a variety of building materials possible.

#### GENERAL

**Max Panel Height**  
Various

**Max Panel Width**  
Various

**Max Glass Thickness**  
10.38mm

**Frame Depth**  
102mm

#### ENERGY

**UW Range**  
4.2-6.1

**SHGC Range**  
0.26-0.74

#### WEATHER

**Maximum Water**  
600 Pa.

#### ACOUSTICS

**6.5mm VLam Hush™**  
34 (0;-3)

**10.50mm VLam Hush™**  
37 (0;-3)

**10.38mm Lam**  
34 (-1;-2)

**6.38mm Lam**  
32 (-2;-3)



BAL-40 compliance may limit glass options. Maximum glass size for BAL-40 products is 5m<sup>2</sup>.

[elevatealuminium.com.au/400](http://elevatealuminium.com.au/400)